



TUBULATOR® with Roller Carried Return (RCR)

The TUBULATOR conveyor, represents the new environment friendly way of transporting bulk goods with high capacity, at high speeds and in an energy saving, dust free and spill free system. The conveyor is built as a closed system of steel tubes. Inside the conveyor tube, a rubber belt runs at high speed on top of an air cushion provided by fans. The TUBULATOR comes in several sizes and can be installed indoors or outdoors. It can be delivered for long transport distances with long self-supporting spans and for capacities up to 800 cu.m/hr.

Proven TUBULATOR Benefits

- Up to 40% higher capacity than same belt width with 45 deg trough design
- Enclosed carrying part for a spill free and dust free transport
- Low maintenance cost with few moving parts
- Low noise level Environment friendly - low power consumption
- 25 m free span between supports
- 75 m free span when using cable towers
- Can be used for step inclinations – up to 25 degrees, with cleated conveyor belts

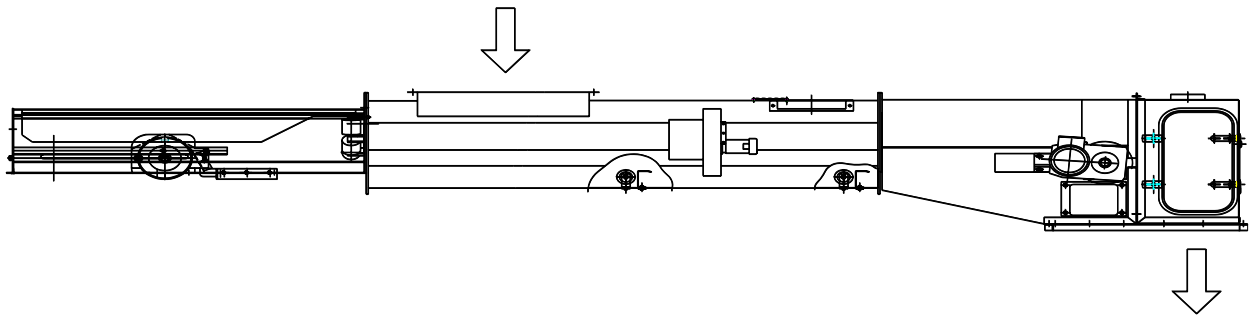

TECHNICAL DATA

Conveying Capacity at 150 m/min (490ft/min) according to CEMA:

EU version	CT500	CT800
Belt width mm	500	800
Capacity (m3 loose/h)	300	800
Capacity TPH	105	280
Motor (kW)	5,5-22	5,5-60
US version		
Belt width inch (mm)	18" (457)	30" (762)
Capacity (m3 loose/h)	218	688
Capacity (ft3/h)	7700	24300
Capacity TPH	76	240
Density: 350 kg/ m3 (22 lb/ft3)		

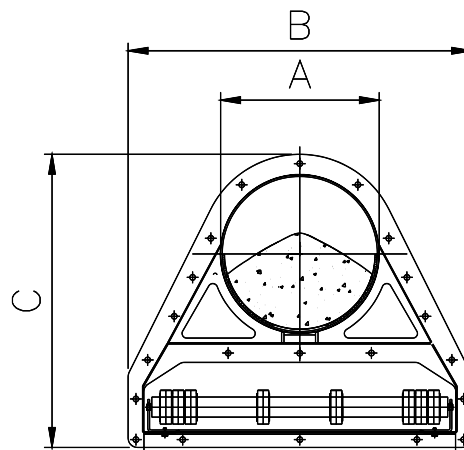

Main dimensions and weights:

Main Dimensions					Weight (Kg)			
CT	A mm	A inch	B mm	C mm	Intermediate sections 12 m	Tail unit	Drive unit	Gravity take-up
500	356,0	14	752	773	1080	300	600	950
800	508,0	20	1102	935	1800	350	750	1200